

Downhold Milling Clamp [Product Type: CES-DMC]

For holding work-piece requiring higher cutting forces.

- Angular sliding jaw provides pull-down and side clamping forces.
- Its typical design and construction is suitable for heavy and rough manufacturing, for example, on planing / plano-milling machines.

Applications: In tool room and machine shop on Planing, Milling, Plano-Milling, Jig Boring, Shaping, Grinding Machines and on VTLs. Also useful as clamping element in the design of fixtures.



Note: T-bolt / Stud shall be supplied with Downhold Milling Clamp only on specific request.

Material:	
Body	High-Tensile S.G. Iron
Jaw Seating	High-Tensile S.G. Iron
Jaw	Heat-Treated Steel; Blackened

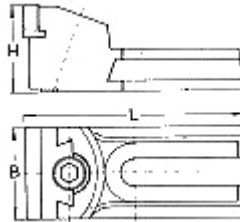

Type	Size (B X H X L) (mm)	Slot	Suitable for Screw	Approx. Clamping Force (kg)	Unit Weight (kg)
DMC-1	58 X 55 X 138	18	Upto M16	1500	1.500
DMC-2	70 X 80 X 190	26	Upto M24	3000	4.100
DMC-3	120 X 135 X 250	35	Upto M30	4500	14.150

Lever Clamp [Product Type: CES-LC]

For angular clamping / medium duty applications.

- Operation of leverage screw provides both vertical downward thrust as well as horizontal clamping force
- Clamping Force adjustable by leverage action

Applications: Suitable for side clamping of big size castings, flanges and regular work pieces on milling, shaping, drilling, plano-milling, grinding machines. Popular with tool designers as clamping element in the design of clamping fixtures.



Material:	
Body	High-Tensile S.G. Iron; Enamelled
Base Plate & Jaw	Medium Carbon Steel
Jaw	Heat-Treated Steel; Blackened

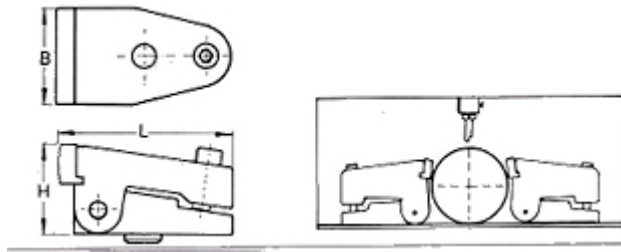

Type	Size (Without T-Nut) (B X H X L) (mm)	Suitable for T-Slot (mm)	Unit Weight (Without T-Nut) (kg)
LC-1	61 X 57 X 110	14 to 28	1.850

Thick Plate Clamp [Product Type: CES-TPC]

Composite forces hold thick plate while machining.

- Forward and downward forces hold work-piece firmly parallel to bed leaving no gap between work-piece and bed surfaces.
- Low height design suitable to hold thick plates from side for machining top of plate in one setting.
- More than one pair employed to hold longer / wider work-piece.

Applications: For side holding of thick plates on milling, shaping, planing, planomilling, drilling, jig boring machines. Suitable for use in design of clamping fixtures.

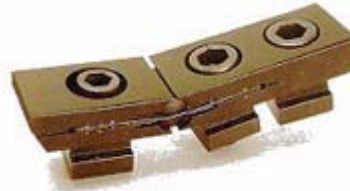

Note: Supplied with screws and T-Nuts of respective sizes.

Material:

Body	Medium Carbon Steel
Jaw	Medium Carbon Steel; Heat-Treated & Blackened

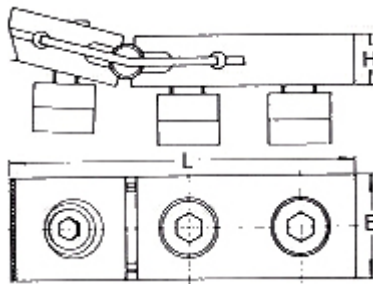

Type	Suitable for T-Slot	Overall Size (Without T-Nut) (B X H X L)	Approx. Clamping Force	Unit Weight (Without T-Nut)
	(mm)	(mm)	(kg)	(kg)
TPC-1	8 or 10	24 X 12 X 82	500	0.140
TPC-2	12 or 14	29 X 15 X 112	700	0.280
TPC-3	16 or 18	39 X 19 X 134	1000	0.750
TPC-4	20 or 22	49 X 24 X 195	1500	1.400

Composite Taper Clamp [Product Type: CES-CTC]

Low type wedge action side clamp for thick plate holding.

- Tightening of screw moves both the jaws offering forward and downward forces, holding the work-piece parallel to the bed.
- Low height design suitable to hold thick plates from side for machining entire top surface in one setting without obstruction.
- Due to split jaw design cylindrical / slightly irregular work-pieces can be clamped effectively.
- More than one pair can be employed to hold longer / wider work-piece.

Applications: For side holding of thick plates on milling, shaping, planing, plano-milling, drilling, jig boring machines. Suitable for use in design of clamping fixtures.



Note: Supplied with screws and T-nuts of respective sizes.

Material:	
Body	Medium Carbon Steel
Jaws	Medium Carbon Steel; Heat-Treated & Blackened

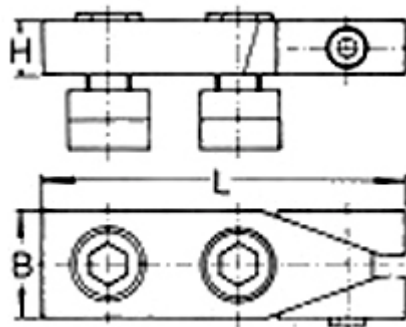

Type	Suitable for T-Slot (mm)	Overall Size (Without T-Nut) (B X H X L) (mm)	Approx. Clamping Force (kg)	Unit Weight (Without T-Nut) (kg)
CTC-1	8 or 10	24 X 12 X 75	400	0.150
CTC-2	12 or 14	29 X 15 X 100	600	0.300
CTC-3	16 or 18	39 X 19 X 115	750	0.470
CTC-4	20 or 22	49 X 24 X 160	900	1.200

Slot Clamp [Product Type: CES-SC]

Low type direct action edge-touch side clamp for thin plate holding.

Major part of clamp body occupied inside T-slot to achieve low height advantage.

Jaw applies clamping force on edge of thin plate, exerting forward and downward forces, avoiding top of surface holding.

Applications: For side holding of thin plates and work pieces of thickness 3mm and above from sides for machining on milling, planing, plano-milling, grinding, drilling machines.

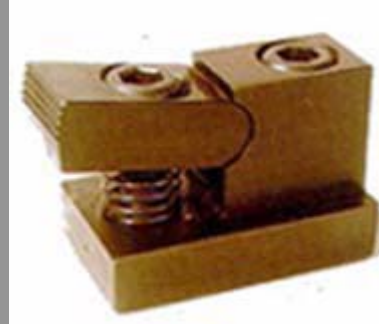

Note: Supplied with screws of respective sizes.

Material:

Body	Medium Carbon Steel
Jaw	Medium Carbon Steel; Heat-Treated & Blackened

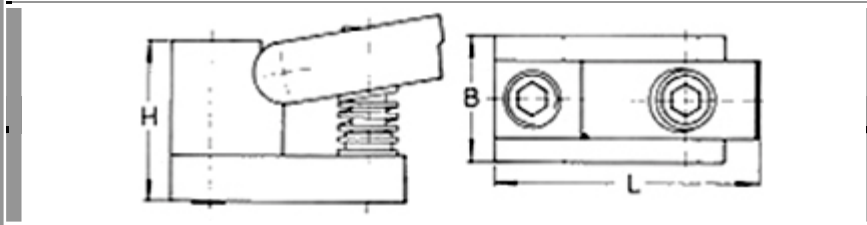

Type	Suitable for T-Slot (mm)	Overall Size (B X H X L) (mm)	Unit Weight (kg)
SC-10	10	15 X 21 X 41	0.055
SC-12	12	20 X 24 X 42	0.100
SC-14	14	23 X 27 X 51	0.140
SC-16	16	25 X 31 X 52	0.180
SC-18	18	29 X 35 X 54	0.230
SC-20	20	32 X 38 X 60	0.320
SC-22	22	35 X 43 X 68	0.520

Stepless Height Clamp - Maxi [Product Type: CES-SHC-MAXI]

&

Stepless Height Clamp - Mini [Product Type: CES-SHC-MINI]

Instant clamping action suitable for vertically acting forces.

Quick action clamping achieved by flicking of clamping lever through 90°, by means of eccentric action.

Clamping pad offers vertical downward thrust on the work-piece.

Requires clamping at minimum two points on job.

Clamping pad swings through 360°, rendering job location at any place for operation.

Height adjusting cylinders of type CES-HAC can be used to increase the height of the clamp.

Material: Heat-Treated Steel; Blackened.

Applications: Suitable for top clamping on machines with T-slots, on pallets with tapped holes and a part of instant clamping element of clamping fixture.



Note: Supplied with T-nut / stud (M12 size) of respective size.

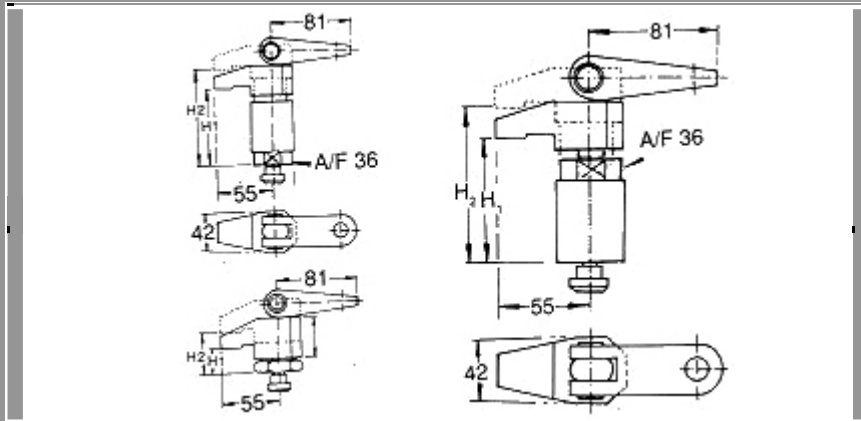

Stepless Height Clamp - Mini

Type	H1 - H2 (mm)	Weight (Without T-Nut) (kg)
SHC-25	25 - 30	1.000
SHC-30	30 - 35	1.150
SHC-35	35 - 40	1.225
SHC-40	40 - 45	1.245
SHC-45	45 - 50	1.275

Stepless Height Clamp - Maxi

Type	H1 - H2 (mm)	Weight (Without T-Nut) (kg)
SHC-70	70 - 105	1.400
SHC-100	100 - 135	1.650

Flat Strap Clamp [Product Type: T1-FSC]



Material: Heat-Treated Steel; Blackened.

Applications: On machines for work holding, on presses for tool holding.

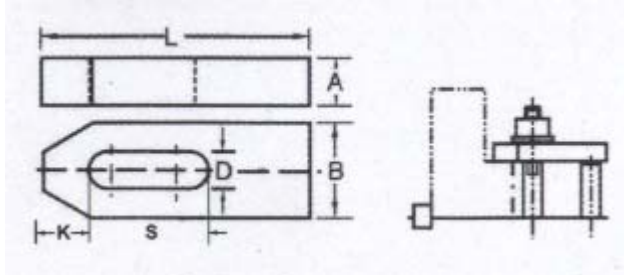

Type	D X L	A	B	K	S	Suitable for Screw Size
	(mm)	(mm)	(mm)	(mm)	(mm)	
T1-FSC-960	9 X 60	14	25	13	22	M8
T1-FSC-1180	11 X 80	16	30	15	30	M10
T1-FSC-14100	14 X 100	20	40	21	40	M12
T1-FSC-14125	14 X 125	20	40	21	50	M12
T1-FSC-18125	18 X 125	25	50	26	45	M16
T1-FSC-18160	18 X 160	25	50	26	65	M16
T1-FSC-22160	22 X 160	35	60	30	60	M20
T1-FSC-22200	22 X 200	35	60	30	80	M20
T1-FSC-26200	26 X 200	35	70	35	80	M20
T1-FSC-26250	26 X 250	40	70	35	105	M24

U Clamp [Product Type: T1-UC]



Material: Heat-Treated Steel; Blackened.

Applications: On Machines for work holding, imparts easiness for insertion / removal due to openness of slot.

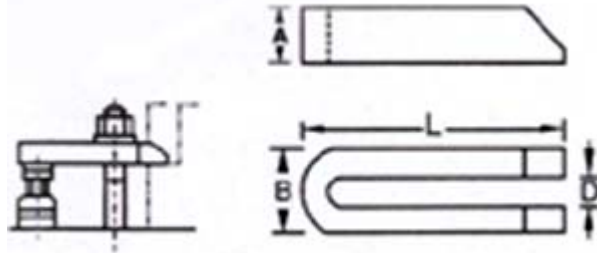

Type	D X L	A	B	Suitable for Screw Size
	(mm)	(mm)	(mm)	
T1-UC-11100	11 X 100	20	31	M10
T1-UC-14125	14 X 125	25	38	M12
T1-UC-14160	14 X 160	25	38	M12
T1-UC-18160	18 X 160	30	48	M16
T1-UC-18200	18 X 200	30	48	M16
T1-UC-22200	22 X 200	40	52	M20
T1-UC-22250	22 X 250	40	62	M20
T1-UC-26200	26 X 200	40	66	M24
T1-UC-26250	26 X 250	40	66	M24

Slotted Clamp [Product Type: T1-SC]



Material: Heat-Treated Steel; Blackened.

Applications: Clamping of medium duty specific work pieces.

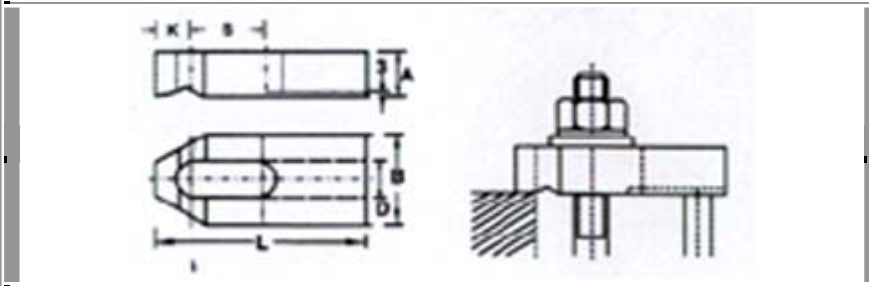

Type	D X L	A	B	K	S	Suitable for Screw Size
	(mm)	(mm)	(mm)	(mm)	(mm)	
T1-SC-1175	11 X 75	16	30	15	20	M10
T1-SC-1195	11 X 95	16	30	15	30	M10
T1-SC-14100	14 X 100	20	40	18	30	M12
T1-SC-14115	14 X 115	20	40	18	38	M12
T1-SC-18120	18 X 120	25	50	21	35	M16
T1-SC-18135	18 X 135	25	50	21	42	M16
T1-SC-22140	22 X 140	30	60	25	40	M20
T1-SC-22150	22 X 150	30	60	25	50	M20
T1-SC-26200	26 X 200	35	70	35	55	M24
T1-SC-26240	26 X 240	35	70	35	75	M24

Table Clamp [Product Type: T1-TC]

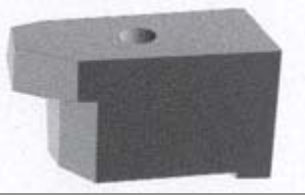

Material: Heat-Treated Steel; Blackened.

Applications: For tool holding and use in jigs & fixtures as holding element.

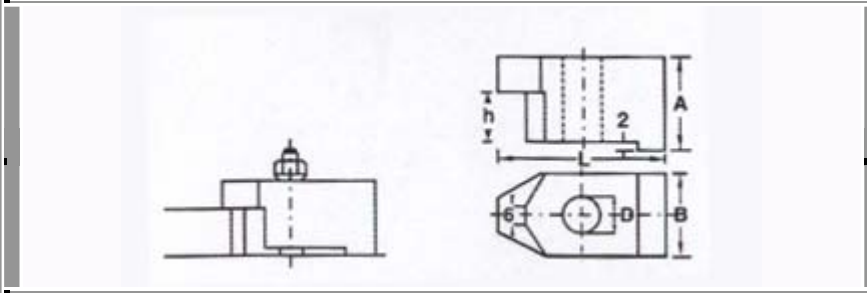

Type	D X A	L	B	H	Suitable for Screw Size
	(mm)	(mm)	(mm)	(mm)	
T1-TC-1123	11 X 23	50	25	13	M10
T1-TC-1130	11 X 30	50	25	20	M10
T1-TC-1426	14 X 26	60	30	13	M12
T1-TC-1433	14 X 33	60	30	20	M12
T1-TC-1835	18 X 35	75	40	20	M16
T1-TC-1840	18 X 40	75	40	25	M16
T1-TC-2240	22 X 40	90	45	20	M20
T1-TC-2245	22 X 45	90	45	25	M20

Double Ended Clamp [Product Type: T1-DEC]



Material: Heat-Treated Steel; Blackened.

Applications: For work holding on machine beds.

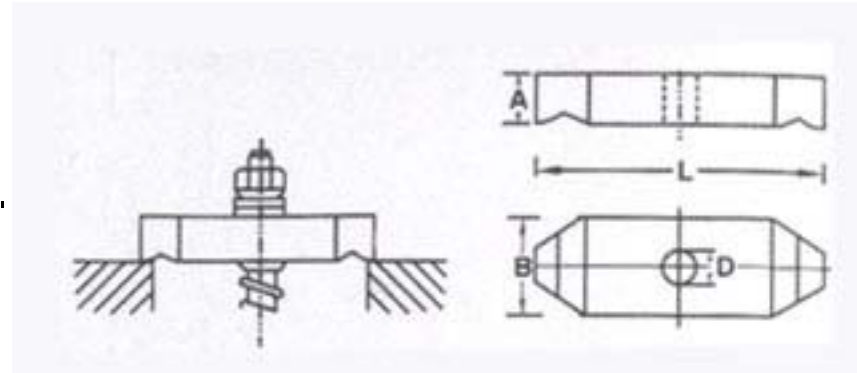

Type	D X L	A	B	Suitable for Screw Size
	(mm)	(mm)	(mm)	
T1-DEC-1160	11 X 60	16	30	M10
T1-DEC-1185	11 X 85	16	30	M10
T1-DEC-14100	14 X 100	20	40	M12
T1-DEC-14125	14 X 125	20	40	M12
T1-DEC-18125	18 X 125	25	50	M16
T1-DEC-18150	18 X 150	25	50	M16
T1-DEC-22150	22 X 150	30	60	M20
T1-DEC-22200	22 X 200	30	60	M20

Goose Neck Clamp [Product Type: T1-GNC]

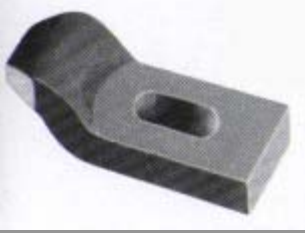

Material: Heat-Treated Steel; Blackened.

Applications: Holding of press-tool and huge castings / dies while machining.

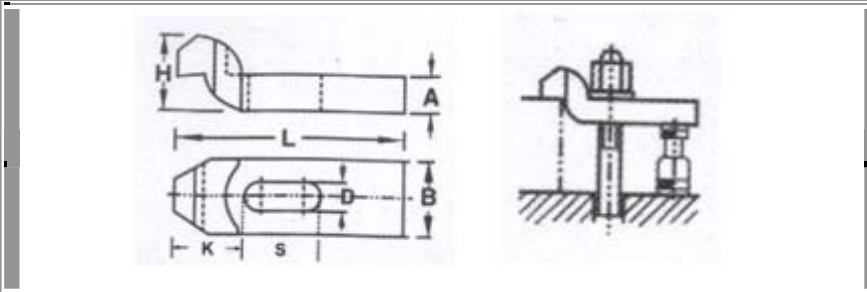

Type	D X L	A	B	H	K	S	Suitable for Screw Size
	(mm)	(mm)	(mm)	(mm)	(mm)	(mm)	
T1-GNC-11100	11 X 100	15	30	30	32	32	M10
T1-GNC-14125	14 X 125	20	40	40	40	40	M12
T1-GNC-18160	18 X 160	25	50	50	49	50	M16
T1-GNC-22200	22 X 200	30	60	60	55	70	M20
T1-GNC-26250	26 X 250	35	70	80	72	80	M24

Plain Clamp [Product Type: T1-PC]



Material: Heat-Treated Steel; Blackened.

Applications: Work holding on various machines.

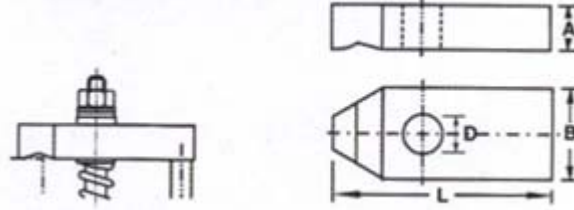

Type	D X L	A	B	Suitable for Screw Size
	(mm)	(mm)	(mm)	
T1-PC-1170	11 X 70	16	30	M10
T1-PC-1480	14 X 80	20	40	M12
T1-PC-18100	18 X 100	25	50	M16
T1-PC-22120	22 X 120	30	60	M20
T1-PC-26150	26 X 150	35	70	M24

Pressing Tool / Milling Clamp [Product Type: T1-PTMC]



Material: Hard S. G. Iron for Clamp and Heat-Treated Steel for T-bolt, Hex-nut & Washer.

Applications: For holding tools/dies on presses and flat components/castings on milling machines.

Note: Set consists of clamp, a T-bolt, a Washer and a Hex Nut.

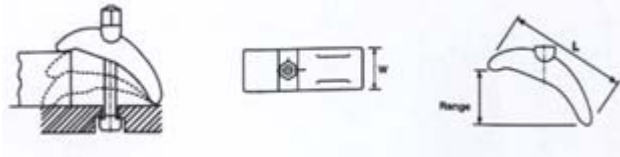

Type	Suitable for T-Slot	Clamp Width (mm)	Clamp Length (mm)	Range (mm)	T-Bolt Type
T1-PTMC-8	8	30	100	0-40	T1-TB-880
T1-PTMC-10	10	30	100	0-35	T1-TB-1080
T1-PTMC-12	12	50	140	0-55	T1-TB-12125
T1-PTMC-14	14	50	140	0-55	T1-TB-14125
T1-PTMC-16	16	50	140	0-70	T1-TB-16160
T1-PTMC-18	18	60	175	0-80	T1-TB-18200
T1-PTMC-20	20	60	175	0-90	T1-TB-20200
T1-PTMC-22	22	60	175	0-90	T1-TB-22200
T1-PTMC-24	24	65	235	0-140	T1-TB-24200
T1-PTMC-28	28	65	235	0-140	T1-TB-28200

Mould Clamp with Heavy Support Bolt [Product Type: T1-MCH]



Ideally suited to hold mould on Injection Moulding machines & die plates on press platen.

Counter height adjustment provided by heavy-duty support bolt with hex and round base and lock-nut.

Applications: Presses, plastic moulding machines, milling / drilling machines and in the design of jigs & fixtures.

Supply: Clamp with support screw and lock-nut standard. T-bolt or stud, Hex hi-nut, Washer optional

Material: Medium carbon steel, heat treated to 8.8 grade

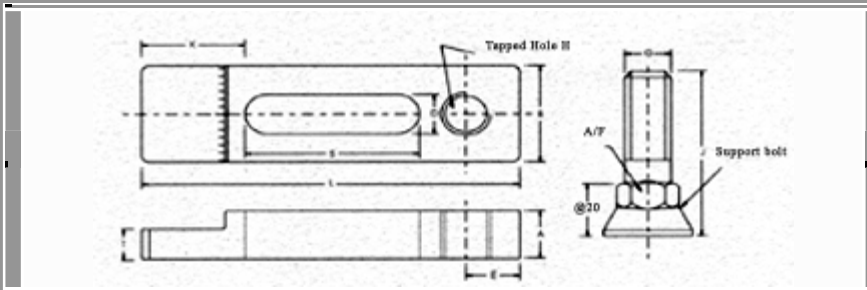
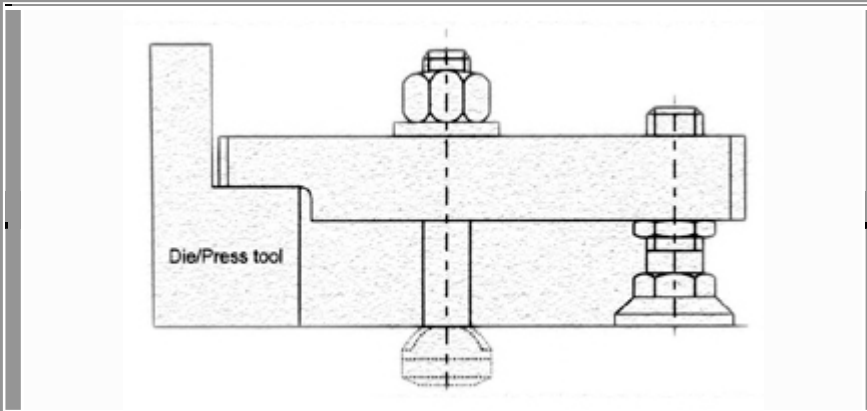

Type	Bolt Size	A	B	D X L	S	T	K	H	E	Support Bolt	
										G X J	Hex A/F X Base
T1-MCH-12115S	M12	24	38	14X115	65	15	20	M16	15	M16X55L	19X35
T1-MCH-12115L	M12	24	38	14X115	65	15	20	M16	15	M16X90L	19X35
T1-MCH-16130S	M16	31	48	18X130	70	20	25	M20	18	M20X60L	24X40
T1-MCH-16130L	M16	31	48	18X130	70	20	25	M20	18	M20X90L	24X40
T1-MCH-16160S	M16	31	48	18X160	90	20	30	M20	20	M20X60L	24X40
T1-MCH-16160L	M16	31	48	18X160	90	20	30	M20	20	M20X90L	24X40
T1-MCH-20140S	M20	38	60	22X140	70	25	35	M24	18	M24X60L	27X50
T1-MCH-20140L	M20	38	60	22X140	70	25	35	M24	18	M24X100L	27X50
T1-MCH-20160S	M20	38	60	22X160	90	30	35	M24	20	M24X60L	27X50
T1-MCH-20160L	M20	45	60	22X160	90	30	35	M24	18	M24X100L	27X50
T1-MCH-20200	M20	45	60	22X200	110	30	45	M24	22	M24X100L	27X50
T1-MCH-24200	M24	48	78	26X200	105	35	45	M27	25	M27X100L	30X55

Quick Clamp [Product Type: T1-QC]



- Instant clamping device with self-adjusting design.
- Multi-locations for saddle offers variable forces.
- Needs negligible setting time.

Applications: Presses, plastic moulding machines, milling / drilling machines, CNC machining centers.

Supply: T-bolt and Flanged Hex-nut standard.

Clamping stud optional.

Material:	
Clamp	High-Tensile S.G. Iron, Duly Painted
Saddle	High-Tensile S.G. Iron, Duly Painted
T-Bolt	Heat Treated to 24-30 HRC, Chemically Blackened
Flanged Hex Nut	Heat Treated to 24-30 HRC, Chemically Blackened

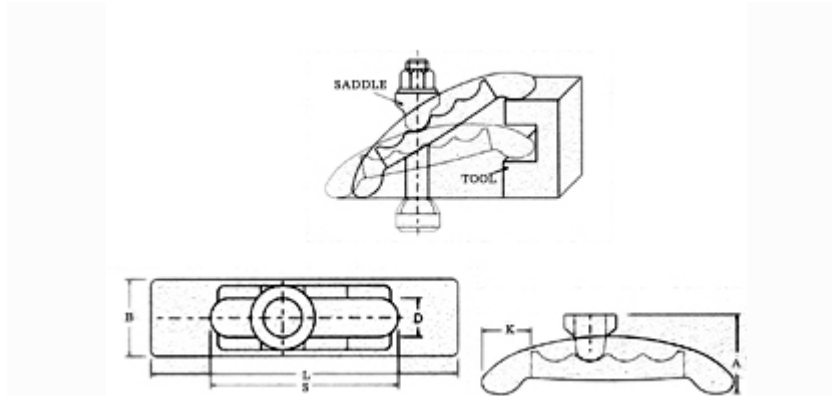

Type	Suitable for T-Slot (mm)	D X S	L X B	A	K	Clamping Range	T-Bolt Size
T1-QC-1/12	12	18X85	130X60	50	16	0-60	M12X12X125 L
T1-QC-1/14	14	18X85	130X60	50	16	0-60	M12X14X125 L
T1-QC-1/16	16	18X85	130X60	50	16	0-60	M16X16X125 L
T1-QC-2/18	18	22X95	160X70	57	32	0-70	M16X18X200 L
T1-QC-2/20	20	22X95	160X70	57	32	0-70	M20X20X200 L
T1-QC-2/22	22	22X95	160X70	57	32	0-70	M20X22X200 L
T1-QC-3/24	24	26X115	185X80	60	36	0-80	M24X24X200 L
T1-QC-3/28	28	26X115	185X80	60	36	0-80	M24X28X200 L

Press Mould Clamp [Product Type: T1-PMC]



- Versatile device. Needs minimum setting time.
- Height and range adjustable at various points.

Applications: Presses, plastic moulding machines, milling / drilling machines.

Supply: T-bolt standard. Clamping stud optional.

Material:	
Clamp	High-Tensile S.G. Iron, Duly Painted
Fulcrum	High-Tensile S.G. Iron, Duly Painted
Saddle	High-Tensile S.G. Iron, Duly Painted
T-Bolt	Heat Treated to 24-30 HRC, Chemically Blackened
Flanged Hex Nut	Heat Treated to 24-30 HRC, Chemically Blackened

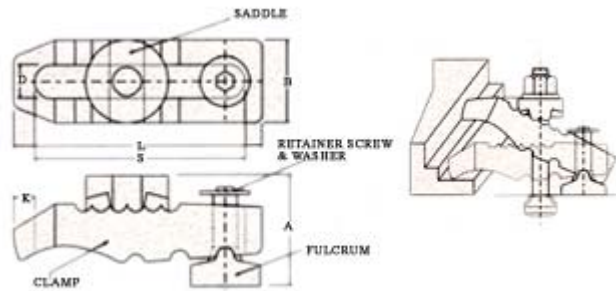

Type	Suitable for T-Slot (mm)	D X S	L X B	A	K	Clamping Range	T-Bolt Size
T1-PMC-1/12	12	18X125	150X50	80	16	0-65	M12X12X125 L
T1-PMC-1/14	14	18X125	150X50	80	16	0-65	M12X14X125 L
T1-PMC-1/16	16	18X125	150X50	80	16	0-65	M16X16X125 L
T1-PMC-2/18	18	22X145	190X60	95	25	0-90	M16X18X200 L
T1-PMC-2/20	20	22X145	190X60	95	25	0-90	M20X20X200 L
T1-PMC-2/22	22	22X145	190X60	95	25	0-90	M20X22X200 L
T1-PMC-3/24	24	26X180	240X65	105	33	0-100	M24X24X200 L
T1-PMC-3/28	28	26X180	240X65	105	33	0-100	M24X28X200 L

Screw Jacks

[Product Type: CES-SJLN] - (With Ring-Type Locknut)



Threads: Trapezoidal
 Stopper provided to avoid accidental dis-engagement of spindle during operation.
 Ring type lock-nut provided to fix-up pre-set height.

Material

Body	High-Tensile S.G. Iron; Enamelled
Spindle	Medium Carbon Steel; Heat-Treated; Blackened

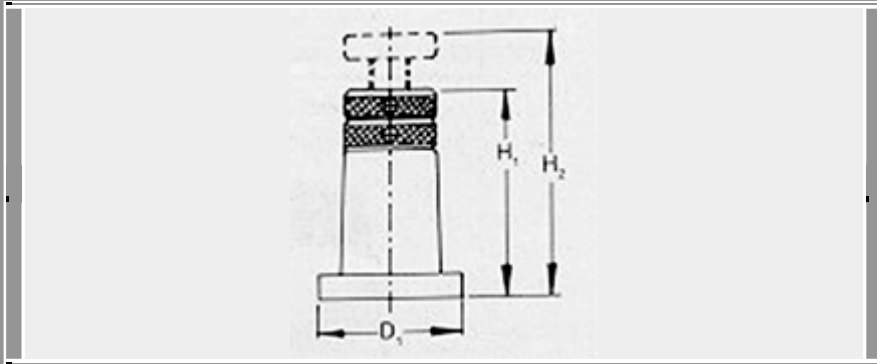

Type	Range H1-H2	Base Dia. D1	Static Load Max.	Weight
	(mm)	(mm)	(kN)	(kg)
CES-SJLN-60	60-80	35	60	0.230
CES-SJLN-85	85-115	45	60	0.610
CES-SJLN-120	120-160	76	100	2.600
CES-SJLN-160	160-220	95	180	4.950

Product Code: CES-50DF]



Threads: Trapezoidal
With double side flange and ring-type locknut. Flange can be bolted to bed for additional rigidity.

Stopper provided to avoid accidental disengagement of spindle during operation.

Material

Body	High-Tensile S.G. Iron; Enamelled
Spindle and Locknut	Medium Carbon Steel; Heat-Treated; Blackened

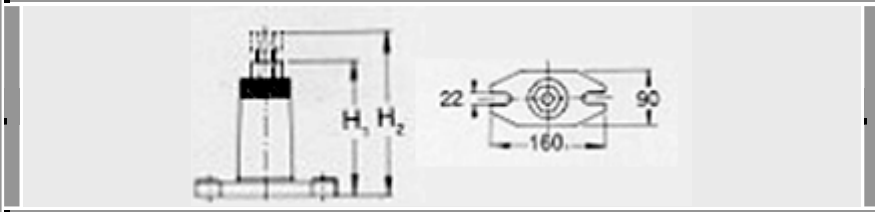

Type	Range H1-H2 (mm)	Base Dia. D1 (mm)	Slot Width (mm)	Base (mm)	Static Load Max. (kN)	Weight (kg)
50DF-200	200-320	50	22	90 X 160	40	4.000
50DF-320	320-550	50	22	90 X 160	25	5.450

[Product Type: CES-50SF]



Threads: Trapezoidal

With single side flange and ring-type locknut. Flange can be bolted to bed for additional rigidity.

Stopper provided to avoid accidental disengagement of spindle during operation.

Material	
Body	High-Tensile S.G. Iron; Enamelled
Spindle and Locknut	Medium Carbon Steel; Heat-Treated; Blackened

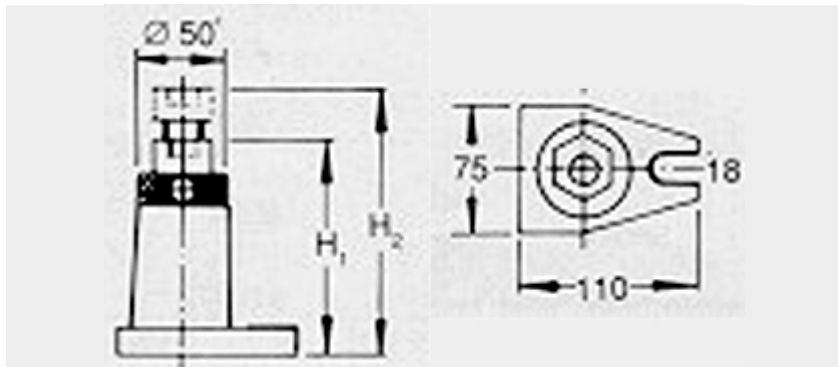

Type	Range H1-H2 (mm)	Base Dia. D1 (mm)	Slot Width (mm)	Static Load Max. (kN)	Weight (kg)
50SF-100	100-140	18	75 X 110	60	1.870
50SF-140	140-200	18	75 X 110	60	2.230

Product Types: CES-70DF, CES-90DF]



Threads: Trapezoidal
 Heavy-duty with double side flange and side locking brass screw. Flange can be bolted to bed for additional rigidity
 Stopper provided to avoid accidental disengagement of spindle during operation.

Material

Body	High-Tensile S.G. Iron; Enamelled
Spindle and Locknut	Medium Carbon Steel; Heat-Treated; Blackened

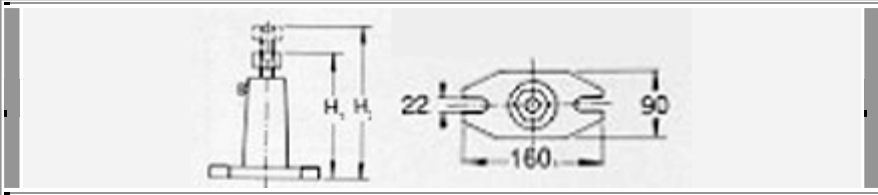

Type	Range H1-H2 (mm)	Barrel Dia. D1 (mm)	Slot Width (mm)	Base (mm)	Static Load Max. (kN)	Weight (kg)
70DF-200	200-320	70	26	190 X 220	80	9.500
70DF-280	280-460	70	26	190 x 220	60	10.750
70DF-430	430-750	70	26	190 x 220	50	14.900
90DF-320	320-450	90	26	190 X 220	80	15.350
90DF-410	410-720	90	26	190 X 220	60	19.200

[Product Type: CES-SBSJ]



Threads: Trapezoidal
 Screw jack with steel body
 Stopper provided to avoid accidental disengagement of spindle during operation.

Material	
Body	Medium Carbon Steel; Heat-Treated; Blackened
Spindle	Medium Carbon Steel; Heat-Treated; Blackened

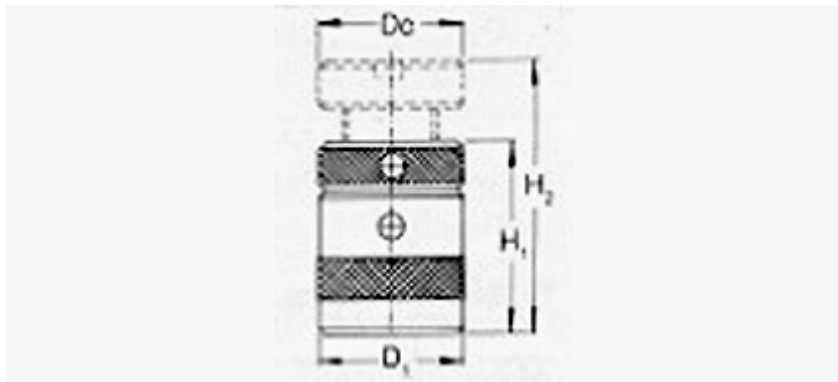

Type	Range H1-H2	Base Dia. D1	Cap Dia. Dc	Static Load Max.	Weight
	(mm)	(mm)	(mm)	(kN)	(kg)
CES-SBSJ-40	40-50	32	32	12	0.230
CES-SBSJ-50	50-70	50	50	60	0.600
CES-SBSJ-70	70-100	50	50	60	0.800
CES-SBSJ-100	100-140	70	65	100	2.500
CES-SBSJ-140	140-210	80	70	165	4.560
CES-SBSJ-190	190-300	98	80	350	9.100

[Product Type: CES-BBLN]



Threads: Trapezoidal

Broader base with ring type lock-nut. Base modified to suit mounting of locating plate and height block types BBLP and BBHB respectively.

Stopper provided to avoid accidental dis-engagement of spindle during operation.

Material	
Body	High-Tensile S.G. Iron, Enamelled
Spindle and Lock-nut	Medium Carbon Steel; Heat-Treated; Blackened

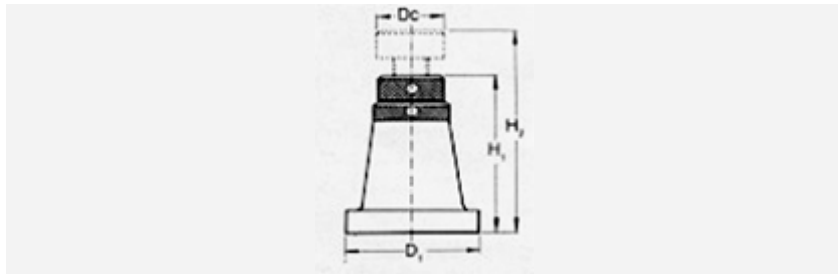

Type	Range H1-H2 (mm)	Base Dia. D1 (mm)	Cap Dia. Dc (mm)	Static Load Max. (kN)	Weight (kg)
BBLN-160	160-220	120	50	100	4.650

[Product Type: CES-SCL]



Threads: Trapezoidal
 With conical head and ring type lock-nut.
 Stopper provided to avoid accidental dis-engagement of spindle during operation.

Material

Body	High-Tensile S.G. Iron; Enamelled
Spindle and Lock-nut	Medium Carbon Steel; Heat-Treated; Blackened

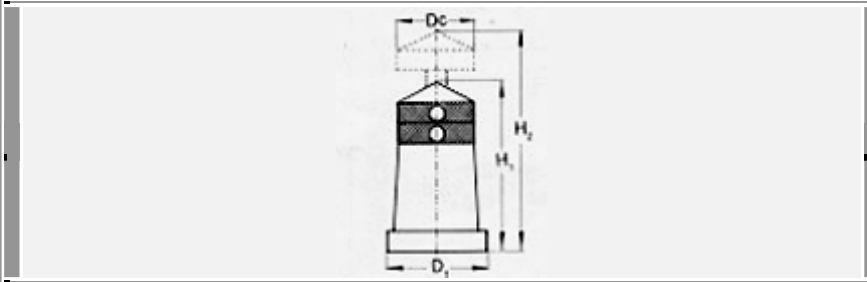

Type	Range H1-H2 (mm)	Base Dia. D1 (mm)	Major Dia. of Cone (mm)	Weight (kg)
SCL-65	65-85	35	25	0.225
SCL-90	90-120	45	35	0.590
SCL-130	130-170	76	60	2.600

[Product Code: CES-STSB]



Threads: V-Rolled
 Swivel Head: With diamond serrations and floating on a ball.
 Stopper provided to avoid accidental dis-engagement of spindle during operation.

Material

Body and Spindle	Medium Carbon Steel; Heat-Treated; Blackened
Swivel Head	Medium Carbon Steel; Heat-Treated; Chrome-plated

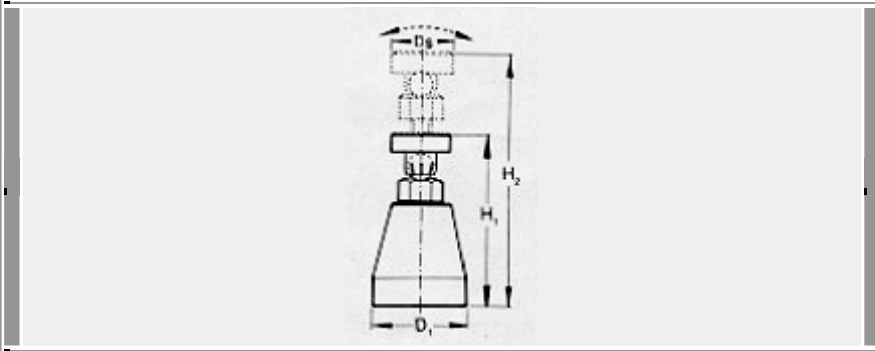

Type	Range H1-H2	Base Dia. D1	Swivel Head Dia. Ds	Head of Spindle	Weight
	(mm)	(mm)	(mm)		(kg)
STSB-45	45-60	25	16	HEX A/F 13	0.090
STSB-55	55-75	32	20	HEX A/F 13	0.190
STSB-75	75-95	40	25	HEX A/F 19	0.380
STSB-95	95-120	56	32	HEX A/F 24	0.920
STSB-105	105-135	60	32	ROUND 25	1.050
STSB-160	160-215	78	40	ROUND 35	3.100

Locating Plate [Product Type: BBLP-120] & Height Block [Product Type: BBHP]



Working height of screw jack type BBLN-160 can be piled up by using locating plates (Type BBLP) and height blocks (Type BBHB).

Height of jack instantly adjustable to suit holding surface of work-piece / holding level clamp.

Material:

Locating Plate	Medium Carbon Steel; Blackened
Blocks	Medium Carbon Steel; Blackened

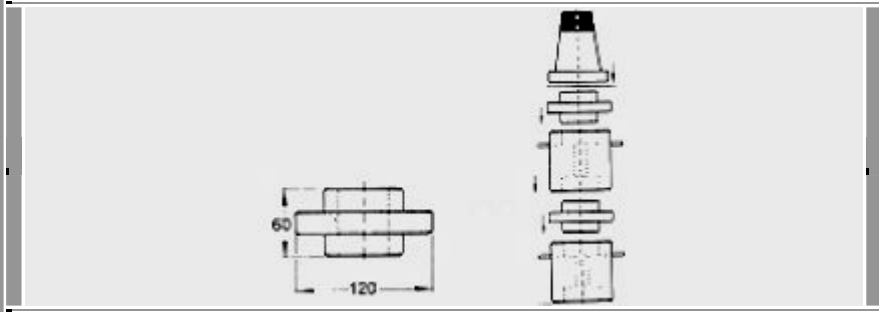

Weight of Locating Plate [Type BBLP-120]: 2.760 kg

Type	Height (mm)	Weight (kg)
BBHB-50	50	1.690
BBHB-100	100	4.110
BBHB-200	200	9.480
BBHB-300	300	15.100
BBHB-400	400	20.100

